

PANOPLAST®

Screw for plastic

With a 40° thread profile and point end, the Panoplast screw is a good compromise between Plastite® and PT® screws.

Main Properties

- Suitable for a wide range of plastics
- Provides maximum resistance to vibration loosening
- Can be removed and screwed in the same hole without performance loss

Features

40° thread profile

- Good compromise between 30° and 60° thread profiles
- Resists to vibration loosening

Body with round section evenly distributes surface contact between application and screw

- Can be removed and screwed in the same hole without significant performance loss
- Improves installed clamp force
- Reduces lowers local stresses in the boss
- Compatible with a wide range of plastics

Point end

- Accepts misalignment between parts to fasten

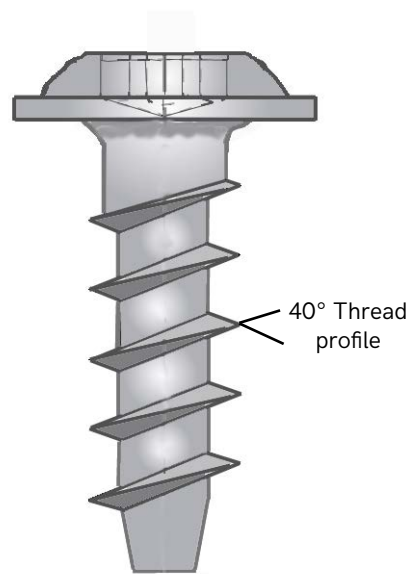

Specifications

- Sizes: \varnothing 3 to 6; other sizes may be available upon request
- Head Styles: Can be used with any external or internal designs, Pan, hexagonal, round, flanged, etc.
- Drive System: Can use any system.
- Finish: As required
- Applications: Thermoplastics with a flexural modulus up to 5800 N/mm²

PANOPLAST®

Screw for plastic

Technical data sheet

Material : Case hardened steel
 Surface hardness: 450-650 Hv0.3
 Core hardness: 270 to 390 HV10

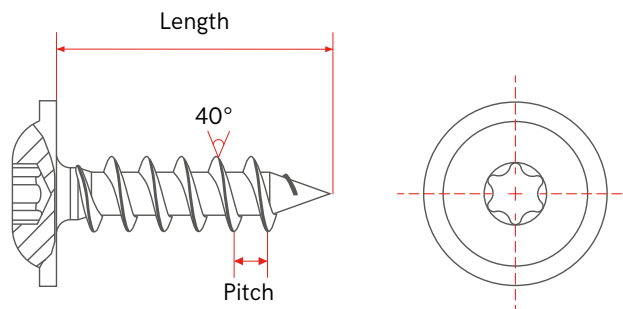

Head shapes

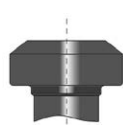

Pan Head

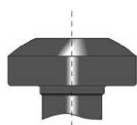

Large Pan Head



Round washer head



Hexagon Head



Hexagon head with flange

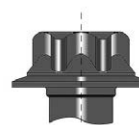

External hexalobular washer head

Socket type

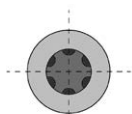

Hexalobe Plus

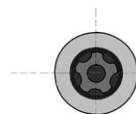

Tamper Hexalobe Plus

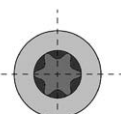

Hexalobe

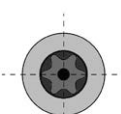

Tamper Hexalobe

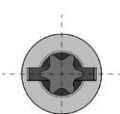

Hexalob + Slot

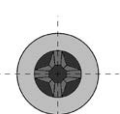

Philips®

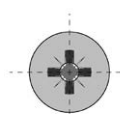

Pozidriv®

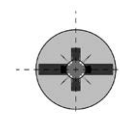

Pozidriv® + Slot

Dia nom.	3.0	3.5	4.0	4.5	5.0	6.0
D	2.80 - 3.00	3.30 - 3.50	3.80 - 4.00	4.30 - 4.50	4.80 - 5.00	5.80 - 6.00
Pitch	1.40	1.60	1.80	2.10	2.30	2.70
Length						
4 +0.5/-1						
6 +0.5/-1						
8 +0.5/-1						
10 +0.5/-1						
12 +0.5/-1						
16 +0.5/-1						
18 +0.5/-1						
20 +0.5/-1						
25 +0.5/-1						
30 +0.5/-1						
35 +0.5/-1						
40 +0.5/-1						
45 +0.5/-1						
50 +0.5/-1						
60 +0.5/-1						
70 +0.5/-1						

Values in mm